

MAIN UNIT DISPLAY

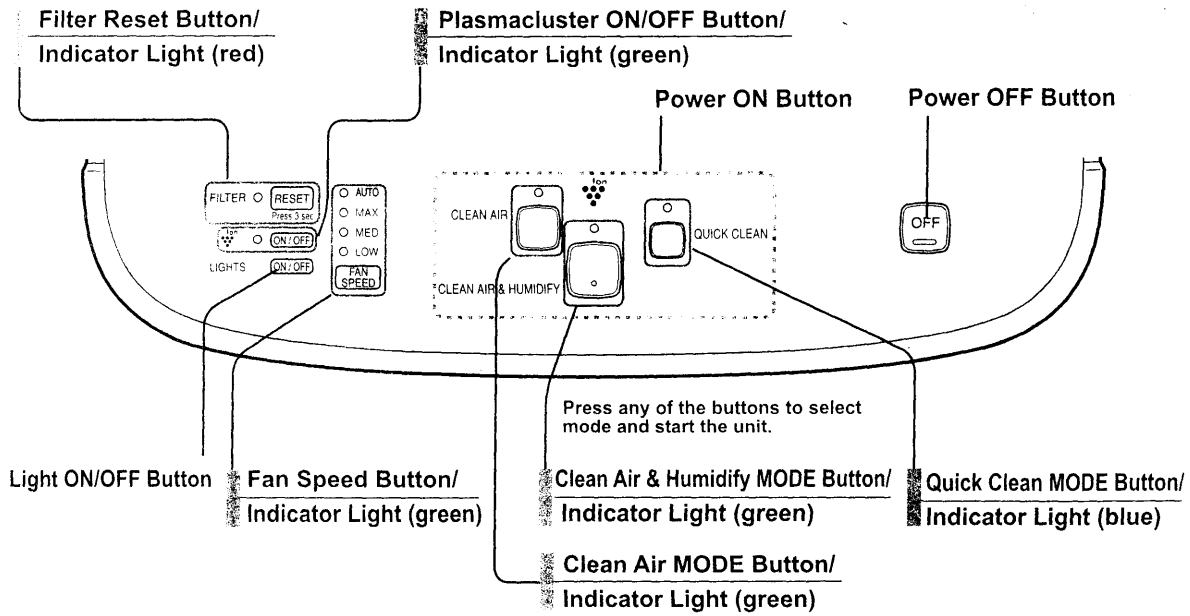

ENGLISH

FRONT MONITOR

Indicates condition and humidity of room air.

Plasmacluster Indicator Light (blue)

Blue : Plasmacluster ON
Light off : Plasmacluster OFF

Humidity Indicator Light (green)

Displays the approximate humidity level in the room. Only displays when the Clean Air & Humidify Mode is selected. Humidity setting cannot be adjusted.

(Ex.) At 60% humidity

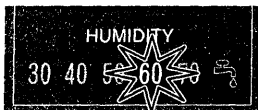

DUST MONITOR

The dust sensor continuously monitors the air and changes color depending on air purity.

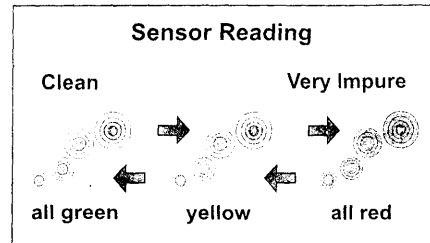

Water Supply Indicator Light (red)

This light will illuminate when the water tank needs to be refilled.

PART NAMES

ILLUSTRATIVE DIAGRAM - FRONT

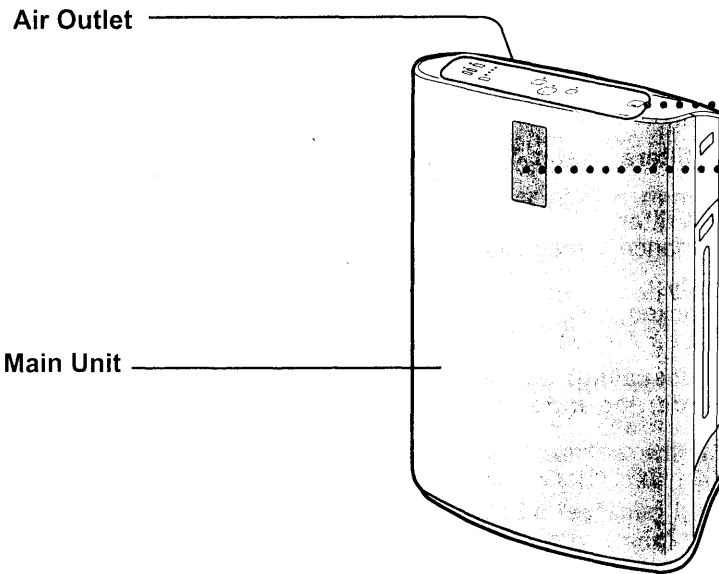

BACK

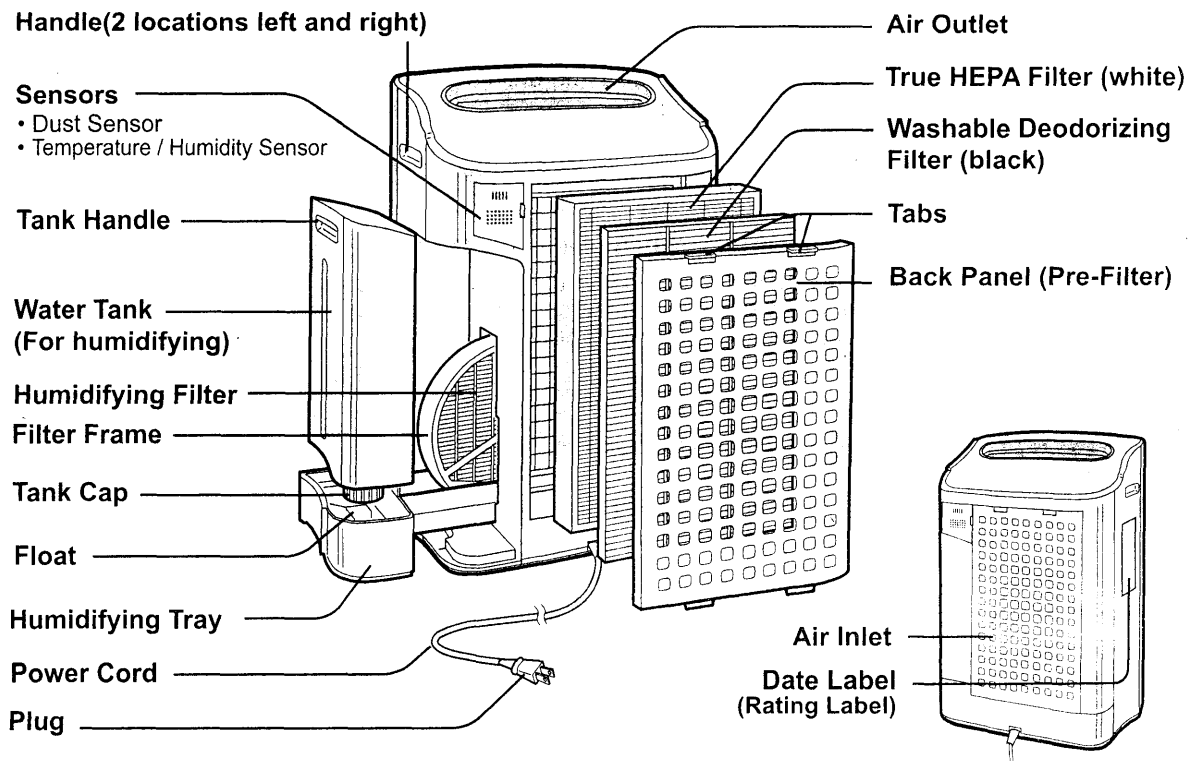

PREPARATION FOR USE

Unplug the unit before installing or adjusting the filters.

FILTER INSTALLATION

To maintain the quality of the filters, they are packed in plastic bags and placed in the unit. Be sure to remove the filters from the plastic bags and replace the filters in the unit before initial use.

1 Remove the filters

1 Remove the Back Panel.

Gently push down on the tabs, then tilt and remove the back panel.

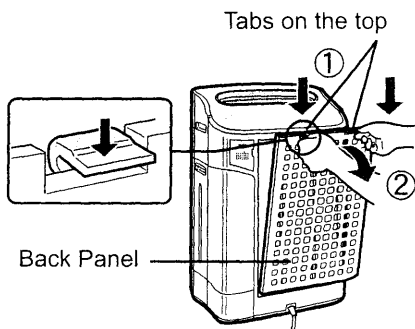

2 Remove the Washable Deodorizing Filter (black) and True HEPA Filter (white) from the plastic bags.

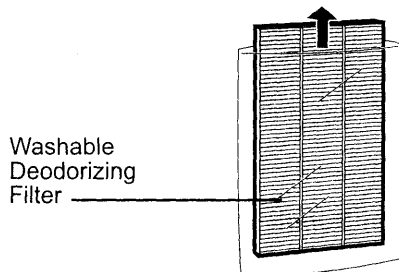
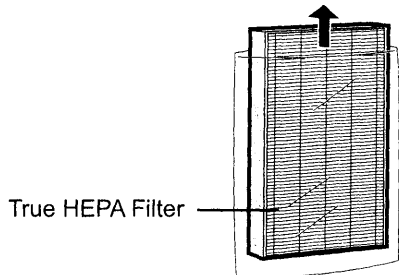

2 Install the filters

1 Install the HEPA Filter.

Please make sure that the True HEPA Filter is placed in proper orientation.

Installing the filter backwards will affect the performance of the unit.

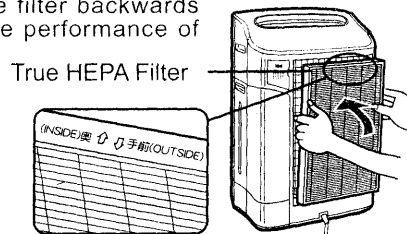

2 Insert the Back Panel's 2 bottom tabs (left and right) into the small holes in the unit, and slide the Washable Deodorizing Filter between the True HEPA Filter and the Back Panel.

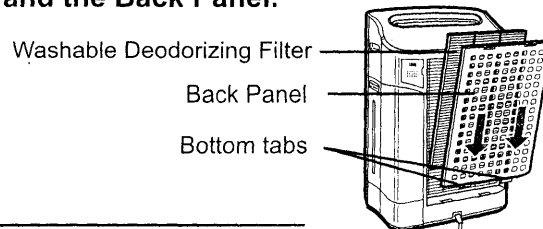

3 Gently push in the upper tabs (left and right) to lock in place.

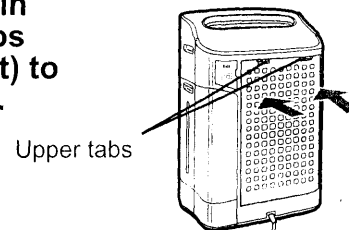

4 Fill in the usage start date on the Date Label.

Use the usage start date as a guide for when the filters should be replaced.

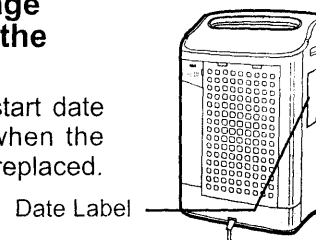

REFILLING THE WATER TANK

The unit can be used in the Clean Air Mode without putting water in the Water Tank. When using the Clean Air & Humidify Mode, or the Quick Clean Mode, the Water Tank should be filled with water.

1 Remove the Water Tank by unlatching the top.

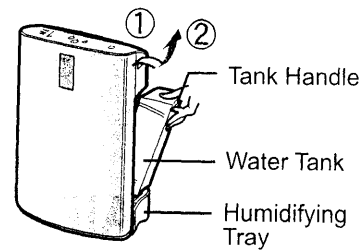

2 Remove the Water Tank Cap and carefully fill the Water Tank with tap water.

- Change the water in the Water Tank every day with fresh tap water.

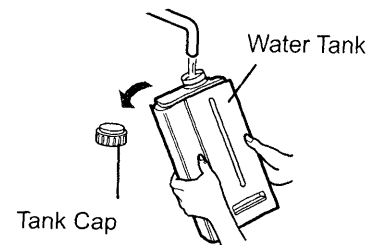

3 After filling, securely tighten the Tank Cap.

- Check to see that there is no water leaking.
- Be sure to wipe off any excess water on the outside of the Water Tank.
- When carrying the Water Tank, hold it with both hands so that the Water Tank opening is facing up.



4 Replace the Water Tank in the unit.

- The top latch will "click" in place when the Water Tank is properly installed.

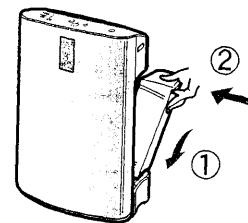

CAUTION

- Do not expose the unit to water. Short circuit and/or electrical shock may occur as a result.
- Do not use hot water (104°F or 40°C), chemical agents, aromatic substances, dirty water, or other damaging substances, deformation and/or malfunction may occur.
- Use only fresh tap water. Use of other water sources may promote the growth of mold, fungus and/or bacteria.